

E 670,500  
N 1,001,000

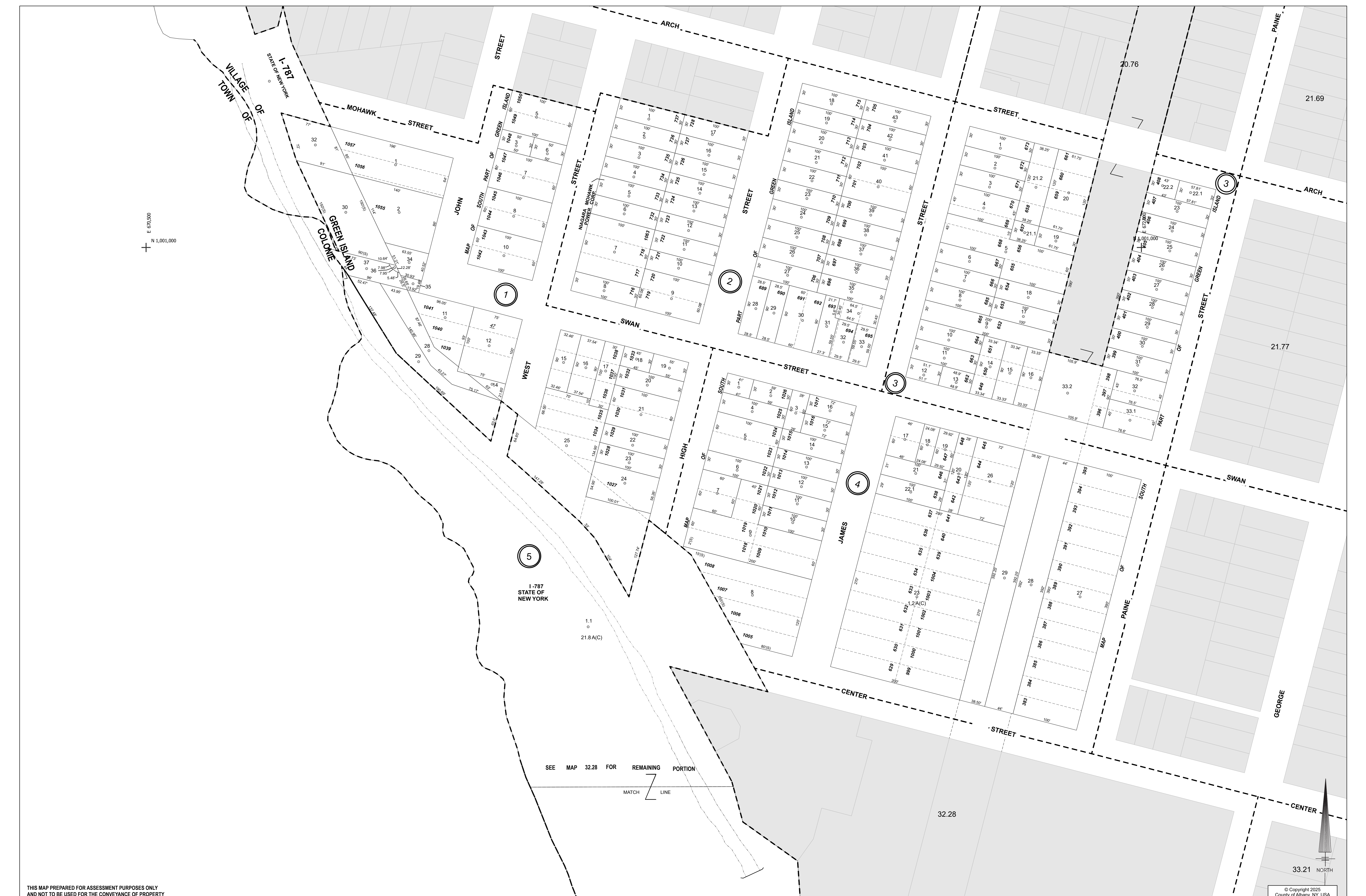

SEE MAP 32.28 FOR REMAINING PORTION  
MATCH LINE

THIS MAP PREPARED FOR ASSESSMENT PURPOSES ONLY  
AND NOT TO BE USED FOR THE CONVEYANCE OF PROPERTY



PREPARED BY SMITH AND MAHONEY,  
ENGINEERS AND SURVEYORS, 1980.  
DIGITAL CONVERSION BY  
THE SANBORN MAP COMPANY INC., 2002.  
CONVERSION TO ESRI PARCEL FABRIC FORMAT BY  
ALBANY COUNTY OFFICE OF REAL PROPERTY, 2023.

COORDINATES BASED ON  
NEW YORK STATE PLANE COORDINATE SYSTEM  
EASTERN ZONE NAD 27

DATE	BY	CHANGES OR ADDITIONS
12/4/2023	JMD	MERGED 1-13 WITH 1-13 PER MAP 14220
1/4/2023	JMD	CREATED 3-11.3, REVISED 11.1 PER MAP 14220
3/20/2019	JMD	CONVEYED PORTION OF 20.76-6.1.1 & CREATED 20.84-4.29 PER INSTRUMENT R2019-4189
12/18/2011	JMD	CONVEYED PORTION OF 20.76-6.1.1 & MERGED WITH 20.84-3.3.2 PER INSTRUMENT R2011-20983
3/8/2011	JMD	CHANGED 4-22 TO 22.1 TO AGREE WITH ASSESSMENT ROLL
6/30/2010	JMD	MERGED 1-4 WITH 1-5 PER L2952-965
4/30/2009	JMD	MERGED 1-26.27.31.33 WITH 1-25 PER L2943-809
1/23/1997	JP	ADDED PARCEL 1.34 PER ASSESSOR

DATE	BY	CHANGES OR ADDITIONS
3/18/1996	RJM	CREATED 1-36 PER 2643-821
11/16/1995	RJM	CREATED 1-34 PER 2536-456
11/16/1995	RJM	CREATED 3-22.1 PER 2531-1136, 3-22.2 PER 2531-1134
3/20/1994	RJM	MERGED 5-2 UNITS 32.28-1.1
4/13/1993	MRJ	ADDED 5-2.6 & 5-3.0
4/13/1992	LML	ADDED 1-31 PER 2444-1042 & 1-32 PER 2492-195
3/20/1991	LML	ADDED 1-30 PER 2415-1649
4/19/1990	DB	ADDED PARCEL 1.29 PER 2401-801

TYPE	SYMBOL	DISTRICT NAME	TYPE	SYMBOL	DISTRICT NAME
School	Sch	Green Island Central School	Water	W	

PROPERTY LINE	CITY LINE	TAX DISTRICT LINE	FIRE DISTRICT LINE
ORIGINAL LOT LINE	VILLAGE LINE	DEPT'S COMMON OWNER	
RAIL ROAD	TOWN LINE	TAX MAP BLOCK NO.	
STREAM OR DITCH	BLOCK LIMIT	TAX MAP PARCEL NO.	
ROAD OR RAIL ROAD ENDRY.	GREAT LOT LINE	STREET NUMBER	
STREET CENTERLINE	EASEMENT LINE	FILED PLAN LOT NO.	
COUNTY LINE	WATER DISTRICT LINE		

GREAT LOT NO.	DEED ACREAGE	SCALED DIMENSION	VISUAL CENTER OF PARCEL
5	7.1 A (C)	725'(5)	○

SHEET INDEX	
20.76	21.69
32.28	33.21

**20.84**

TAX MAP  
VILLAGE OF GREEN ISLAND  
TOWN OF GREEN ISLAND  
ALBANY COUNTY, NEW YORK

0 25 50 100 Feet  
1" = 50'

TAXABLE STATUS DATE: 3/1/25